

TOILET ACCESSORIES (FUTURE)

TOILET ACCESSORIES EQUAL TO BOBRICK NUMBERS SHOWN. ACCESSORIES SHALL BE FURNISHED AND INSTALLED BY CONTRACTOR OR SUBCONTRACTOR THROUGH OWNER'S VENDOR. (CONFIRM ALL NUMBERS PRIOR TO ORDERING) (CONTACT OWNER'S REPRESENTATIVE FOR VENDOR.)

- MIRRORS: NO. B-163 SERIES MODEL 1830, 18" WIDE X 36" HIGH, ONE MIRROR OVER EACH LAVATORY WITH TOP AT 70" AFF.
- GRAB BAR: NO. B-6806 X 42" LONG, CONCEALED MOUNTING BAR TO SUPPORT 300 LBS. APPLIED VERT. BAR TO BE MOUNTED CENTER ± 2'-3" AFF.
- VERTICAL GRAB BAR: NO. B-6803 X 24" LONG, CONCEALED MOUNTING BAR TO SUPPORT A MIN. OF 300 LBS APPLIED VERTICALLY.
- GRAB BAR: NO. B-6803 X 36" LONG, CONCEALED MOUNTING BAR TO SUPPORT A MIN. OF 300 LBS APPLIED VERTICALLY BAR TO BE MOUNTED CENTER ± 2'-3" AFF.
- TOILET TISSUE DISPENSER: KIMBERLY-CLARK ITEM# 0956600 JRJUMBO 66 AT WATER CLOSET IN TOILET. MOUNT CENTER ± 20" AFF.
- TOWEL DISPENSER: KIMBERLY-CLARK LEV-R-MATIC II ITEM# 0933600 2" SMOKE UNIV. TOWEL DISP. MOUNT BOTTOM ± 40" AFF.
- SOAP DISPENSER: KIMBERLY-CLARK SANI-TUFF ITEM# 911011 800 MILLILITER MOUNT BOTTOM ± 40" AFF.

PLUMBING FIXTURE SCHEDULE (FUTURE)

MARK	DESCRIPTION	MANUFACTURER	MODEL	SUPPLY FITTING	STOP & SUPPLY	WATER H	C	WASTE FITTING	TRAP	REMARKS	FLOW RATE GPM	GPF
P1	ADA WATER CLOSET TANK	KOHLER CIMMERON	K3496	INTEGRAL	1/2" x 3/8"	---	1/2"	INTEGRAL	INTEGRAL	NOTE 1, 2a	---	1.5
P2	LAVATORY/ WALL HUNG	KOHLER	K-2196-1-0	CHICAGO 2200 CP	1/2" x 3/8"	1/2"	1/2"	MESQUITE 155A DRAIN	1-1/4" C.P.	NOTE 2, 2c, 9	0.5	---
P3	WATER HEATER	RINNAI	RUR-199e	---	---	3/4"	3/4"	---	---	NOTE 8	---	---
P4	URINAL	ZURN ONE	Z5738.207.01	---	1/2" x 1/2"	1/2"	1/2"	INTEGRAL	3"	NOTE 2, 2b	---	1.3
P5	JANITOR SINK	MUSTEE	G5M	T&S B0654	1/2" x 1/2"	1/2"	1/2"	---	2"	NOTE 5, 6	---	---
P6	GREASE RECEPTOR	CUSTOM	TBD	---	---	---	---	---	4"	NOTE 10	75 (MIN)	---
P7	FLOOR DRAIN	ZURN	ZN415B	INTEGRAL TRAP PRIMER CONNECTION	---	---	1/2"	---	3"	NOTE 4	---	---

FURNISH THE FOLLOWING ITEMS AS INDICATED IN THE REMARKS COLUMN. (SUBMIT ANY EQUALS FOR APPROVAL)

- PROVIDE BENEKE 527 SS SEAT - WHITE
- MOUNT AT HANDICAP HEIGHT PER ADA GUIDELINES
- PROVIDE ZURN Z1231 CONCEAL ARM SUPPORT
- PROVIDE ZURN Z1222 CONCEAL ARM SUPPORT
- WALL MOUNT STAINLESS STEEL (NOTE 7)
- TRAP PRIMER - REFER TO BLDGS 'B' & 'C'
- PROVIDE CURB & FRP SURROUND. (OPTIONAL)
- PROVIDE w/ VACUUM BREAKER, PAIL HOOK, WALL BRACE, & THRESHOLD HOSE OUTLET
- PROVIDED BY OWNER, INSTALLED BY CONTRACTOR
- REFER TO SUPPLIER INFORMATION FOR R/I REQUIREMENTS (VERIFY LOCATION w/ OWNER PRIOR TO R/I)
- FURNISH w/ ASSE 1070 MIXING VALVE TO SUPPLY TEMPERED WATER & TRUE BRO 102-E2 GUARDS
- MUST BE MFG BY CITY OF DOTHAN APPROVED VENDOR.
- POP-OFF/ ROUTE TO JANITOR SINK (BLDG 'C' ONLY)
- 115/1/60, MOUNT H-SPOUT @ 33" A.F.F. w/ MIN CLEARANCE OF 27" (BLDG 'B' ONLY)
- MOUNT LOW-SPOUT @ 33" A.F.F. w/ MIN CLEARANCE OF 27" (BLDG 'B' ONLY)

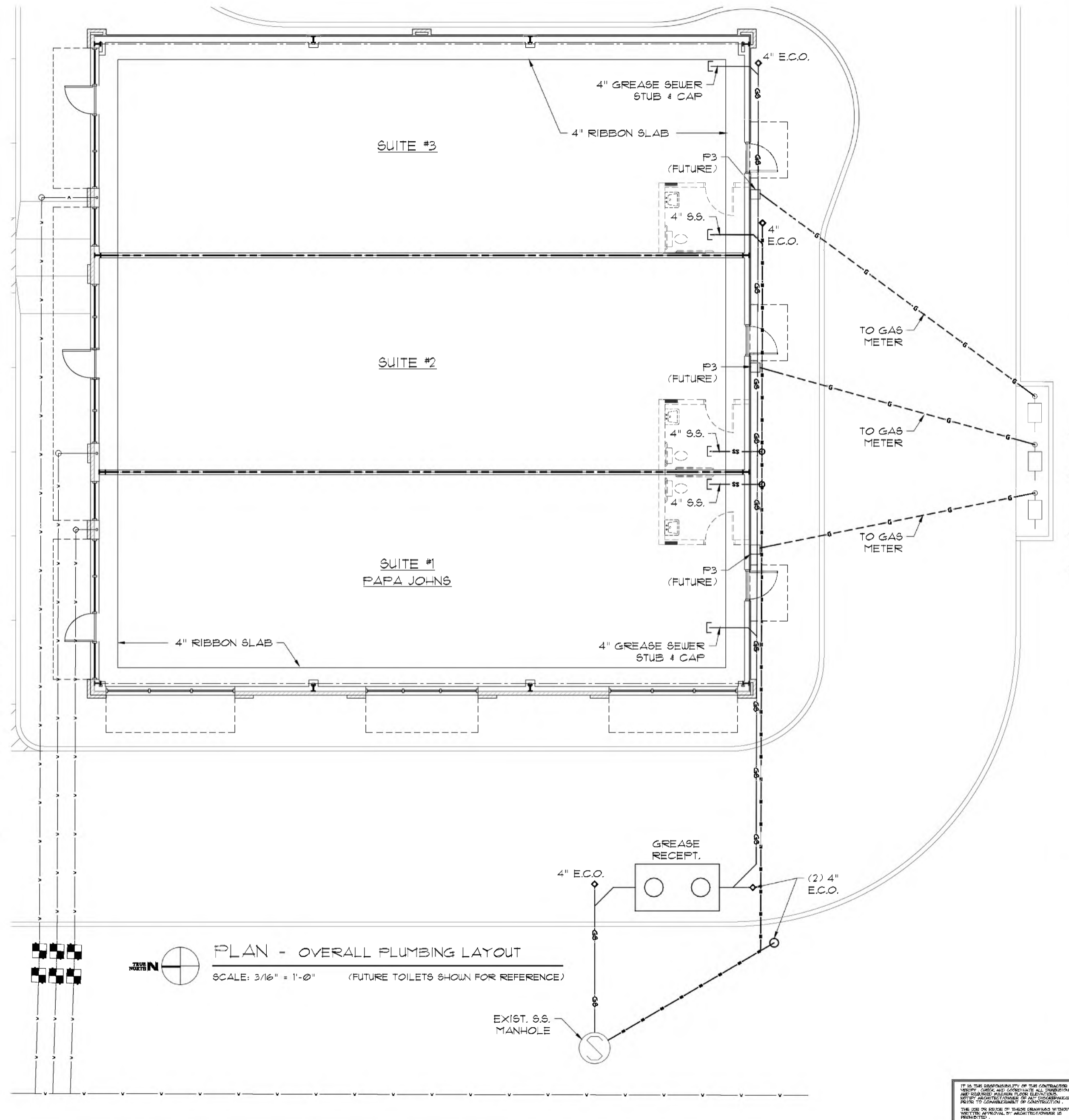

PLAN - OVERALL PLUMBING LAYOUT
 SCALE: 3/16" = 1'-0" (FUTURE TOILETS SHOWN FOR REFERENCE)

REVISIONS

NO.	DESCRIPTION

FOR PERMITS -

FOR PRICING -

CLIENT REVIEW -

DRAWN BY: JUM/P

PLT DATE: 9-17-24

PROJ. DATE: 9-19-24

SHEET: P1.1 OF 3

866 25 01 22
 JOB No. 24170

IT IS THE RESPONSIBILITY OF THE CONTRACTOR TO VERIFY, CHECK AND CORRECT ALL DIMENSIONS AND REQUIRED MINIMUM FLOOR ELEVATIONS. NOTIFY ARCHITECT IMMEDIATELY OF ANY DISCREPANCIES PRIOR TO COMMENCEMENT OF CONSTRUCTION. THE JOB OR DESIGN OR THESE DRAWINGS WITHOUT WRITTEN APPROVAL BY ARCHITECT/OWNER IS PROHIBITED.